

Faucets and Showers



Pale Grey/White Angled Housing



Pale Grey/White Straight Housing

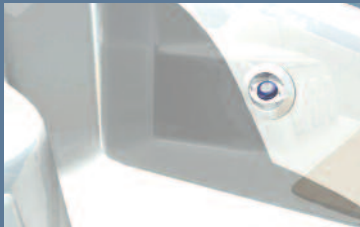

Unobtrusive Sleek Design



Easy to Use

NEW Whale Twist™ Deck Shower - Award Winning Design

A Radical Innovation in Deck Showers Putting control in your hands

Unique Integrated Handset

- Incorporates shower temperature and flow controls
- Easy to use-streamlined ergonomic design
- High quality UV resistant ASA materials

No Lids or Covers

- Deck Protect™ End Cap creates a splash-proof seal

Ease of Installation

- Compact unobtrusive housing
- Only one circular hole to cut and simple plumbing connection

Mounts in Convenient Locations

- Housing options offer a choice of horizontal or vertical mounting on a flat or curved surface

Ease of installation

The new Whale Twist™ Deck Shower is quick and easy to install. It is available with either a chrome straight housing, or a white angled housing, both of which require only a single circular hole to be drilled.

Plumbing

All Whale Twist™ Deck Shower models are easy to plumb. Mixer models include a temporary shut off valve as standard.

Aesthetics

The Whale Twist™ Deck Shower is also available in a choice of either blue and white or pale grey and white colour combinations, with a chromed end cap and white 2.5 m (8.2 ft.) or 4 m (13.1 ft) length hose both as standard.

Unique Whale Twist™ Handset



Long life
Marine-grade materials

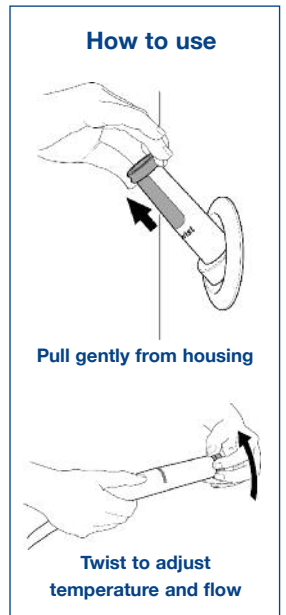

AWARD WINNING DESIGN
Institute of Designers in Ireland - Product Design Award

Model Specifications

Model	Whale Twist™ Deck Shower
Weight	130 g (0.3 lbs) / 200g (0.45 lbs)
Hose Length	2.5 m (8.2 ft) / 4 m (13.1 ft) – see models list below
Hose Connections	1/2" threaded connections
Materials	Handset - ASA, Internal parts -TPE, Nitrile, POM, Hose - Reinforced Polyurethane, Hose connections - PBT, End Cap - Chromed ABS, Straight Housing - Chromed ABS, glass-filled Polypropylene, Angled Housing - ASA, Screws and Hose Clips - Stainless Steel

Whale Twist™ bulk packed models for boatbuilders (bulk packed 5 per carton)

Product Code	Description
DS0001B	Whale Twist™ Deck Shower Cold only handset (blue and white) with straight housing (chrome) 2.5 m (8.2 ft) hose
DS0002B	Whale Twist™ Deck Shower Cold only handset (blue and white) with angled housing (white) 2.5 m (8.2 ft) hose
DS0003B	Whale Twist™ Deck Shower Mixer handset (blue and white) with straight housing (chrome) 2.5 m (8.2 ft) hose
DS0004B	Whale Twist™ Deck Shower Mixer handset (blue and white) with angled housing (white) 2.5 m (8.2 ft) hose
DS0011B	Whale Twist™ Deck Shower Cold only handset (pale grey and white) with straight housing (chrome) 2.5 m (8.2 ft) hose
DS0012B	Whale Twist™ Deck Shower Cold only handset (pale grey and white) with angled housing (white) 2.5 m (8.2 ft) hose
DS0013B	Whale Twist™ Deck Shower Mixer handset (pale grey and white) with straight housing (chrome) 2.5 m (8.2 ft) hose
DS0014B	Whale Twist™ Deck Shower Mixer handset (pale grey and white) with angled housing (white) 2.5 m (8.2 ft) hose
DS0411B	Whale Twist™ Deck Shower Cold only handset (pale grey and white) with straight housing (chrome) 4 m (13.1 ft) hose
DS0412B	Whale Twist™ Deck Shower Cold only handset (pale grey and white) with angled housing (white) 4 m (13.1 ft) hose
DS0413B	Whale Twist™ Deck Shower Mixer handset (pale grey and white) with straight housing (chrome) 4 m (13.1 ft) hose
DS0414B	Whale Twist™ Deck Shower Mixer handset (pale grey and white) with angled housing (white) 4 m (13.1 ft) hose

Whale Twist™ Retail packed models (individual carton)

Product Code	Description
DS0005	Whale Twist™ Deck Shower Cold only (Pale grey / white) with 2.5 m (8.2ft) white hose. Includes straight housing (chrome) and angled housing (white)
DS0006	Whale Twist™ Deck Shower - Mixer (Pale grey / white) with 2.5 m (8.2ft) white hose. Includes straight housing (chrome) and angled housing (white)

Note: Retail packed models include plumbing connections for 15 mm Whale Quick Connect or 1/2" threaded

The Whale Twist™ Deck Shower is protected by the following patent and design registration applications:

USA Patent number:	0621530.5
European Patent number:	07119601.8
Norway Patent number:	0621530.5
New Zealand Patent number:	562931
Australian Patent number:	2007231705
USA Patent number:	11/814640
UK Patent number:	0711496.0
UK Patent number:	0719338.6

Design Registration:

European:	000760632.0001
European:	760632
European:	000305957
Australian:	21517/2007
Australian:	21518/2007
Canadian:	124293
Canadian:	124924
USA:	29/299,514
USA:	29/299,515

WHALE TWIST™ and DECK PROTECT™ are trade marks of Munster Simms Engineering Limited (also trading as Whale Water Systems).

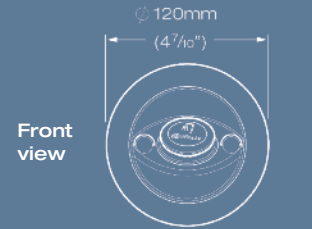

Front view

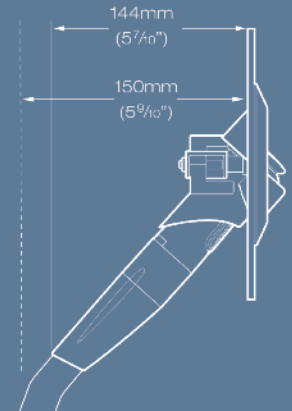

Side view

Angled Housing

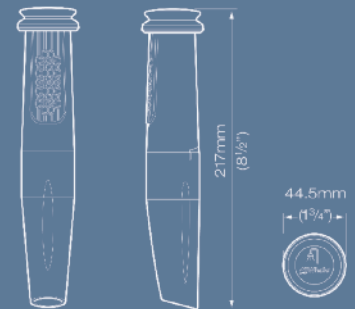

Handset

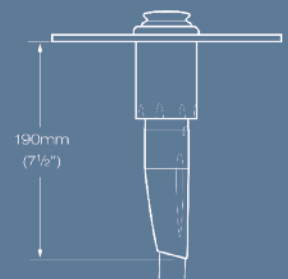

Straight Housing

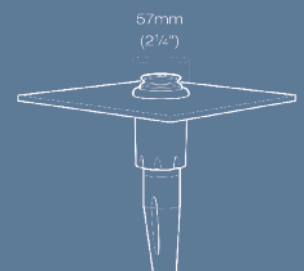

Straight Housing